

# SPARE PARTS SECTION

## SAND BLAST CABINET

**Model. SB-420**

Order Code S302

*Edition No : SB-420-1*

*Date of Issue : 06/2022*

The following section covers the spare parts diagrams and lists that were current at the time this manual was originally printed. Due to continuous improvements of the machine, changes may be made at any time without notification.

### HOW TO ORDER SPARE PARTS

1. Have your machines model number, serial number & date of manufacture on hand, these can be found on the specification plate mounted on the machine
2. A scanned copy of your parts list/diagram with required spare part/s identified.

**NOTE: SOME PARTS MAY ONLY BE AVAILABLE AS AN ASSEMBLY**

3. Go to [www.machineryhouse.com.au/contactus](http://www.machineryhouse.com.au/contactus) and fill out the inquiry form attaching a copy of scanned parts list.

**SPARE PARTS DIAGRAM**

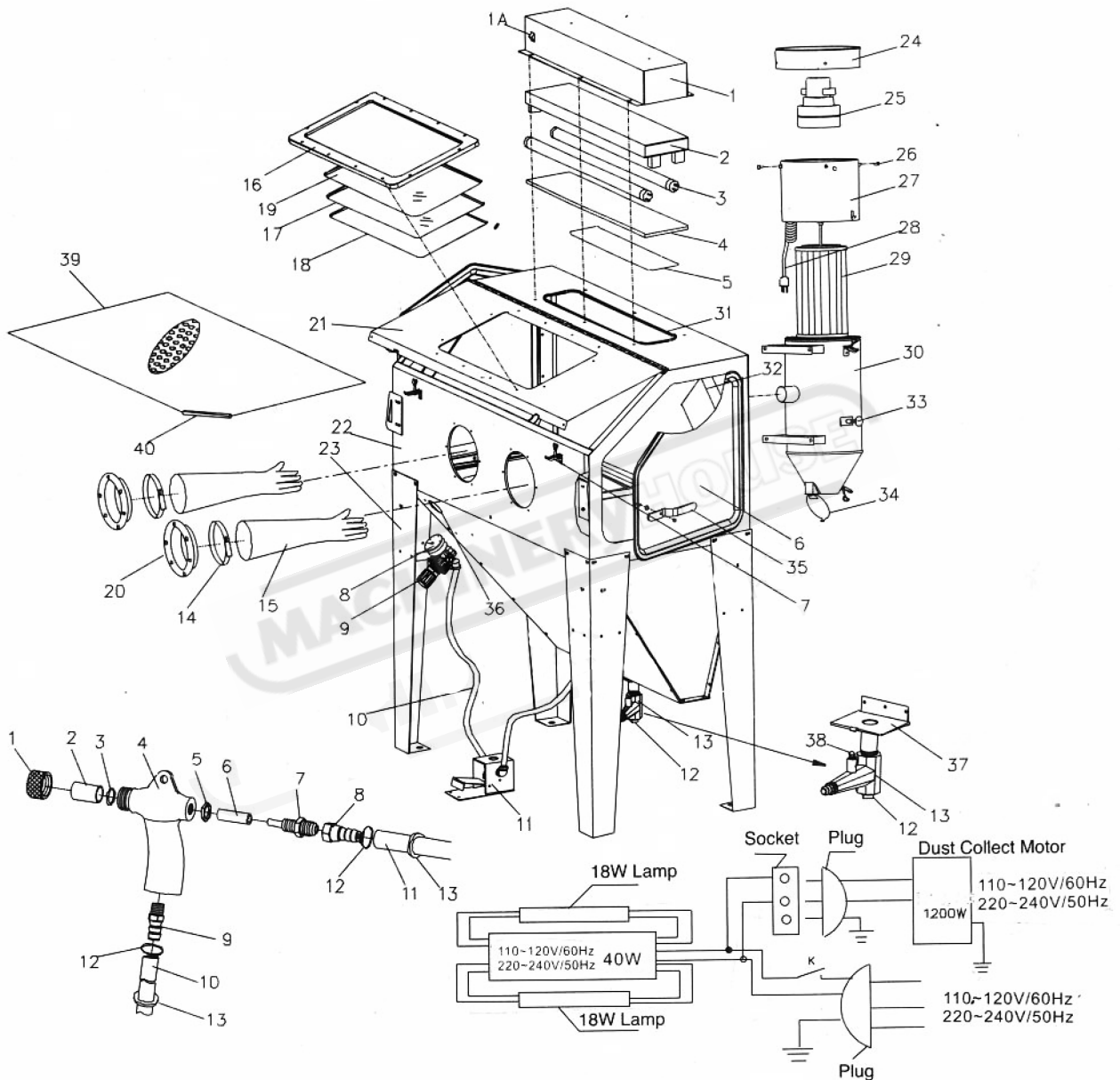

**SPARE PARTS LIST Cabinet**

Item	DESCRIPTION	Item	DESCRIPTION
1	Lamp Housing	21	Lid Cabinet
1A	Switch	22	Cabinet
2	Lamp Fixture, 2 Bulbs	23	Legs, Cabinet
3	Lamp	24	Top of DC
4	Lamp Window	25	Vacuum Motor
5	Trim-Lock Window Seal, PE	26	Screws
6	Side Door	27	Cover Motor
7	Door Latch	28	Power Cord
8	Pressure Gauge 1/4" 150psi	29	Dust Filter
9	Regulator Air 3/8"	30	Round Dust Collector
10	Hose Air Push on 1/2"	31	Sealing Tape
11	3/8" Foot Pedal Complete	32	Board, Exhaust
12	Metering Valve Plug	33	Push Rod
13	Metering Valve	34	Cap Dust Collector
14	Clamp Gloves	35	Side Door Post
15	Gloves, Pair	36	Hole
16	Window Frame Cover	37	Cover
17	Glass	38	Bolt
18	Protection Film, PE	39	Web
19	Plastic Board	40	Rubber Stop
20	Mounting Ring, Gloves		

**SPARE PARTS LIST Gun**

Item	DESCRIPTION
1	Nozzle Holding Brass Nut Ceramic
2	Nozzle Set (4 pce) 4, 5, 6, 7mm
3	O-Ring, Nozzle
4	Gun Body, Mod-U-Blast (Only)
5	Air Jet Hex Nut, Brass
6	Sleeve Air Jet
7	Air Jet
8	Swivel Air Inlet Fitting, 3/8"
9	Media Inlet Fitting, Barb 3/8"
10	Hose Media 1/2"
11	Hose Air, 1/2"
12	Seal
13	Ring